



# Sherrill Faw Realty, LLC

307 10th Street, North Wilkesboro, NC 28659



*A Christian Office* Office: 336-903-0060



**Sherrill Faw**  
Broker-in-charge  
336-957-7600



**Joe McMillan**  
Broker  
336-984-5549



**Jane Pierce**  
Office Manager



**Bonnie Alday**  
BIC Assistant



**Darla Terrell**  
Marketing Manager

## NEW LISTING OWNER FINANCING AVAILABLE

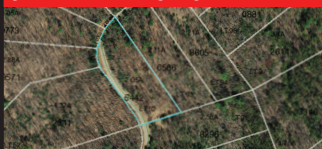

**Lot 92 Sutters Ridge**  
2.05 acres of located in a beautiful residential restricted neighborhood.  
MLS 1082993 \$24,900

## NEW LISTING OWNER FINANCING AVAILABLE



**180 Chestnut Mtn Farms**  
17.55 acres in a restricted Equestrian Community with riding trails, barn, paved roads & great views.  
MLS 1084232 \$45,000

## NEW LISTING OWNER FINANCING AVAILABLE

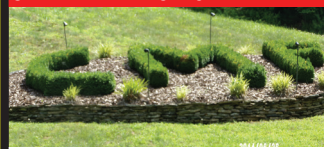

**227 Chestnut Mtn Farms**  
10.01 acres in a restricted high class Equestrian Community with great views.  
MLS 1084234 \$35,000

## OWNER FINANCING AVAILABLE



**Lot 5 Smith Ridgecrest Rd**  
0.40 acre lot. Great location for double wide mobile home or starter home.  
MLS 956482 \$11,900

## REDUCED



**Lot 4 Browntown Rd**  
Cleared level lot in private peaceful setting. 3.4 acres of land.  
MLS 1051403 \$47,000



**Grissel Tail Rd 16.40 Acres**  
Privacy and big timbered woods all around. Stone Mtn. Park is only 2 miles away.  
MLS 1079657 \$49,900



**Hawkins Grove Rd 6.90**  
Private location minutes away from the Thurmond Chatham Game Lands.  
MLS 1080656 \$39,900



**Lot 21 Spring Dr**  
0.73 acre level lot located in a great neighborhood down highway 115.  
MLS 1048470 \$12,900



**Lot 4 Sherwood Forest**  
0.98 acre corner lot. Owner financing available with 10% down payment.  
MLS 918633 \$14,900



**43 Bull Mtn**  
1.21 acres in a gated community with long range views. Owner financing.  
MLS 1015051 \$19,900



**Mountain View Estates**  
Lot 1 has 0.72 acres of land in the Hays Community for residential use.  
MLS 959992 \$9,999



**TBD Highland North Rd**  
6.59 acres of land to build your dream home. Only 12 miles to the Blue Ridge Parkway.  
MLS 1071205 \$74,900

Email: [sherrillfaw@sherrillfaw.com](mailto:sherrillfaw@sherrillfaw.com) • [joemcmillan@sherrillfaw.com](mailto:joemcmillan@sherrillfaw.com) • Website: [sherrillfaw.com](http://sherrillfaw.com)





## Sherrill Faw Realty & ValueBuild Homes

A winning combination for your land and construction needs!



**ValueBuild**  
HOMES

Sherrill Faw • 336.903.0060 • sherrillfaw.com

Mark Mull • 336.934.2313 • valuebuildhomes.com

*Please pray for a cure for the virus, everyone's safety and a worldwide revival & coming back to God.*

### 8 tracts of Land for Sale in Myers Estate



Lot 1	3.80 acres - \$36,500
Lot 2	4.43 acres - \$42,500
Lot 3	11.41 acres - \$79,500
Lot 4	10.26 acres - \$75,900
Lot 5	5.67 acres - \$49,500
Lot 6	3.72 acres - \$39,900
Lot 7	3.13 acres - \$30,900
Lot 8	3.63 acres - \$34,500

Nearest mailbox address: 2100 Arlie Myers Store Rd

**OWNER FINANCING AVAILABLE**

### COMMERCIAL RENTAL



**315 Main St. N Wilkesboro**  
2000+/- sq feet, 5 offices, 3 baths, reception/waiting area, new paint & flooring. Fiber optics have been installed. **\$2000 per month**

### COMMERCIAL RENTAL



**924 Main St N Wilkesboro**  
For lease 120 sqft - 1,200 sqft Professional office space with private parking, 24 hr access, elevator & high-speed internet. Call for pricing.

### COMMERCIAL PROPERTY



**TBD Gateway Avenue**  
1.51 Acre Lot. Ideal location for apartments, hotel, restaurant, or retail establishment.  
**MLS 1075580 \$ 399,000**

### COMMERCIAL PROPERTY



**Gateway Avenue**  
2.66 Acre Lot on Hwy 421 in Wilkesboro with high traffic count.  
**MLS 1075587 \$499,000**

### FOR SALE OR TRADE



**DRONE VIDEO ON YOUTUBE**  
<https://youtu.be/FnVFgHKAGSM>

### 100 Finley Ave

Approximately 14,000+ sqft brick Southern Colonial that offers many possibilities. This property would be perfect for a bed & breakfast, church, dance studio, a multi-family or even a single-family mansion. The building is on a corner 4.20 acre parcel with a large paved parking lot and paved roads all around. Situated on top of the highest hill in North Wilkesboro gives this property great visibility from highway 18N, Finley Ave and Reynolds Rd and is also close to Samaritans Purse. Water and sewer are already in place and we have a price for a new roof.

**MLS: 1051766**

**Price: \$445,000**



### REDUCED



**401 2nd St**  
1.5 acre lot in prime location for fast food, gas, retail, etc. Access to existing traffic signal.  
**MLS 951585 \$349,000**

### LUXURY EQUESTRIAN COMMUNITY

#### Great 80+ Acres

Leatherwood Mountains is a gated luxury residential community & vacation resort located in the Blue Ridge Mountains. These 80.20 acres are to be developed under the guidelines of Leatherwood Mtns. subdivision.

**MLS 1068503**

**\$399,000**



Go to our website [www.sherrillfaw.com](http://www.sherrillfaw.com) and click on the "for sale" tabs on the left hand side to see listings.